

Existing Site Plan

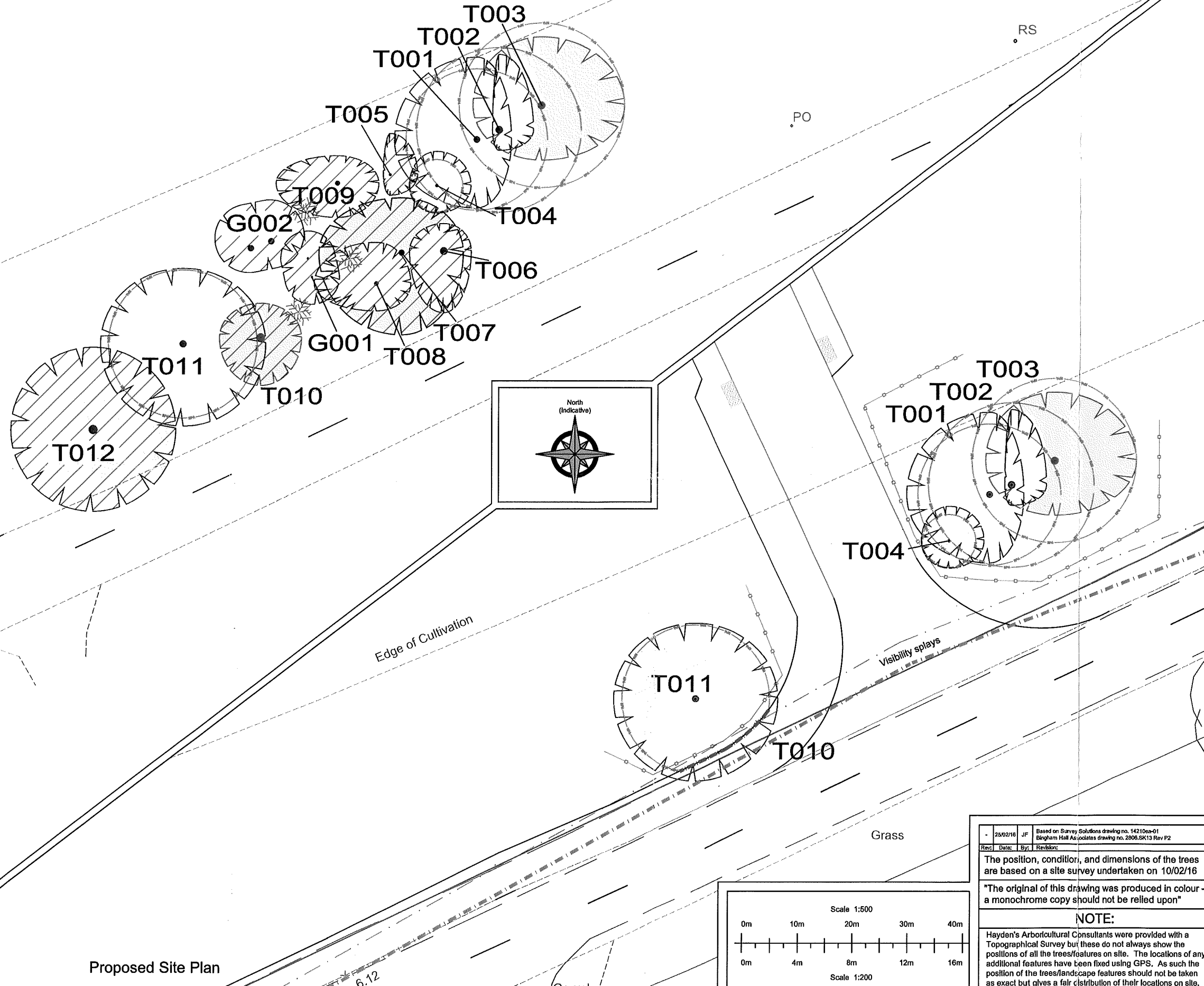

Proposed Site Plan

CATEGORY AND DEFINITION

Trees unsuitable for retention	
Category U	Those in such condition that they cannot realistically be retained as living trees in the current land use for longer than 10 years
Trees to be considered for retention	
Category A	Trees of high quality with an estimated remaining life expectancy of at least 40 years
Category B	Trees of moderate quality with an estimated remaining life expectancy of at least 20 years
Category C	Trees of low quality with an estimated remaining life expectancy of at least 10 years, or young trees with a stem diameter below 150mm

LEGEND

	Existing Tree/Hedge BS 5837:2012 Category B
	Existing Tree/Hedge BS 5837:2012 Category C
	Existing Tree/Hedge BS 5837:2012 Category U
	Line of Root Protection Area (RPA) - calculated following guidelines set in BS 5837:2012
	Dead or Dying Tree
	Existing Tree/Hedge to be removed to allow for development BS 5837:2012 Category B
	Existing Tree/Hedge to be removed to allow for development BS 5837:2012 Category C
	Existing Tree/Hedge to be removed to allow for development BS 5837:2012 Category U
	Line of proposed temporary protective barrier (see appendix F.3)



© HAYDEN'S 2016

5 Moseleys Farm Business Centre
 Fornham All Saints,
 Bury St Edmunds
 Suffolk IP28 6JY
 Tel: 01284 765391
 Mobile: 07850 167400
 Twitter: @treesurveyors
 Email: info@treesurveyors.co.uk
 Web Page: www.treesurveyors.co.uk

25/02/16	JF	Based on Survey Solutions drawing no. 14210ea-01 Bingham Hill Associates drawing no. 2806.SK13 Rev P2
Rev:	Date:	By:

The position, condition, and dimensions of the trees are based on a site survey undertaken on 10/02/16

The original of this drawing was produced in colour - a monochrome copy should not be relied upon

NOTE:

Hayden's Arboricultural Consultants were provided with a Topographical Survey but these do not always show the positions of all the trees/features on site. The locations of any additional features have been fixed using GPS. As such the position of the trees/landscape features should not be taken as exact but gives a fair distribution of their locations on site.

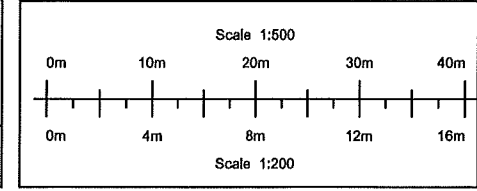

Evolution Town Planning LLP		TS & AIA
Lakenheath North, Station Road, Lakenheath, Suffolk		
Date:	Drawn By:	Client File Ref:
25/02/16	JF	CllPro5201-D - Lakenheath North - TS & AIA.dwg
Scale:	Checked By:	Drawing No:
1:200 (A2)	AG/DG	5201-D

Highway Layout
Scale 1:2000

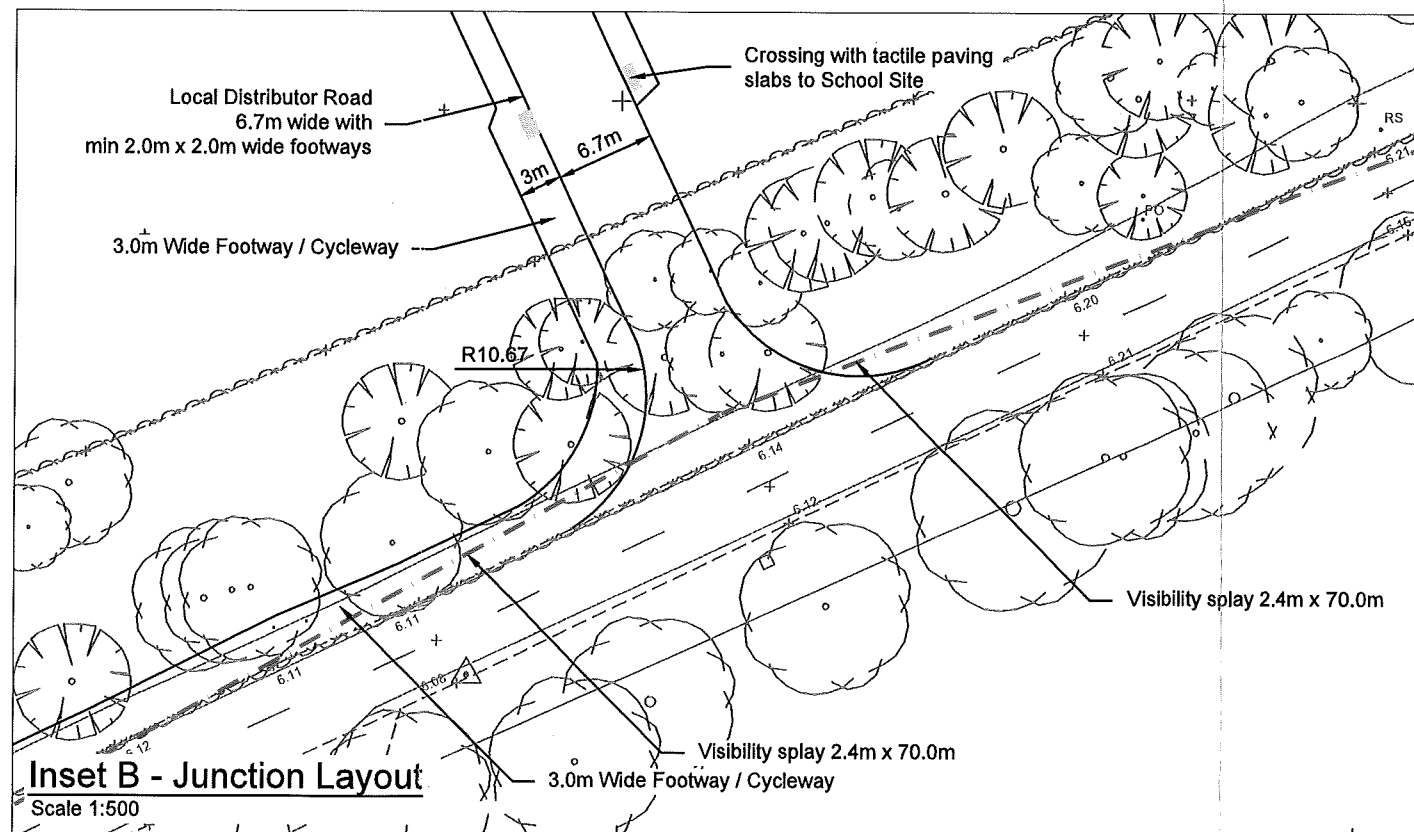
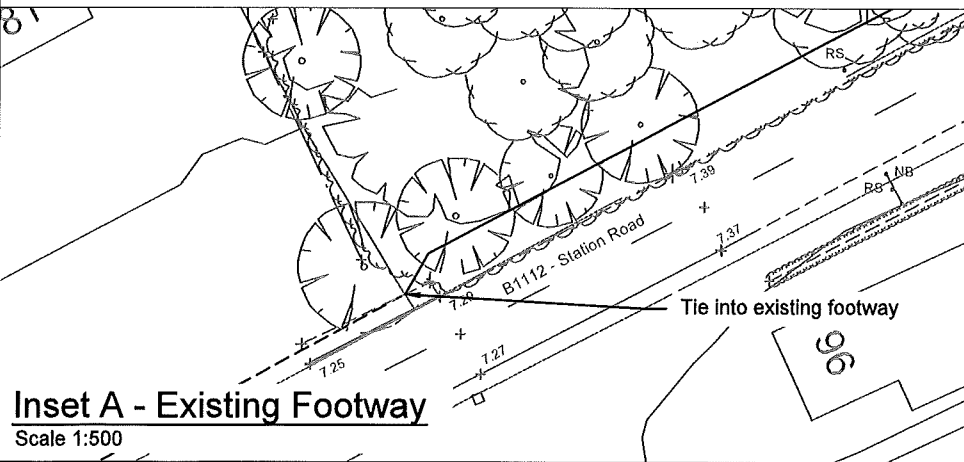
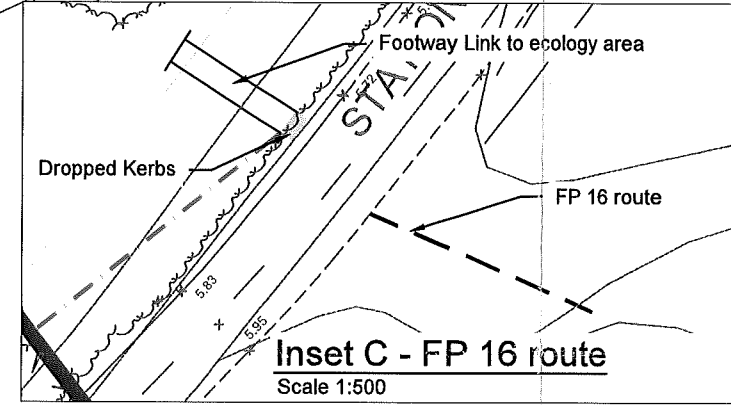
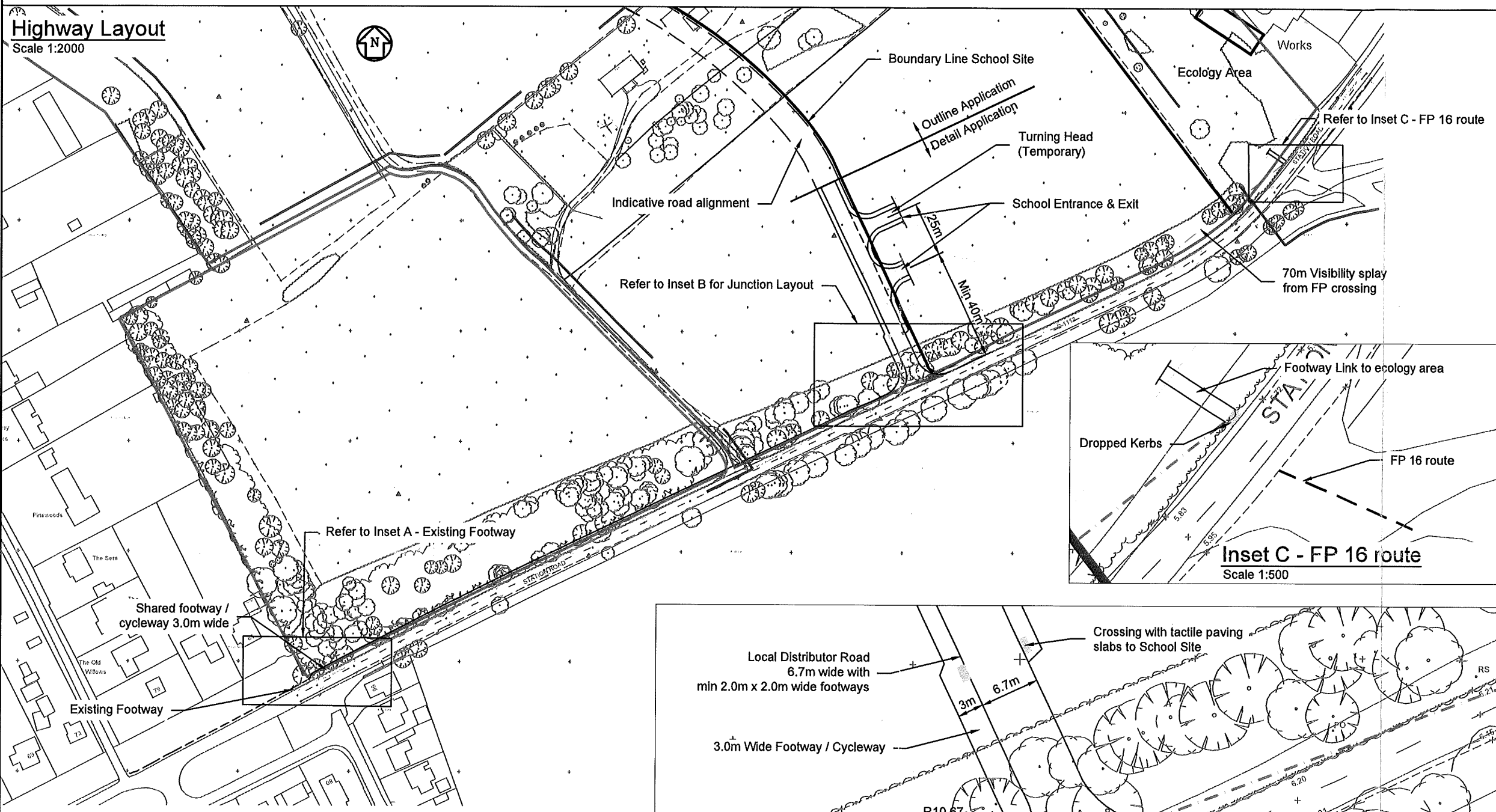

- GENERAL NOTES**
1. This drawing and the works depicted thereon are the copyright of BHA Consulting Ltd. Unauthorised reproduction infringes copyright.
 2. All dimensions are in millimetres unless stated otherwise.
 3. Do not scale from this drawing.
 4. This drawing should be read in conjunction with Bingham Hall Associates engineering related drawings and all relevant drawings by the Architect and other specialists.

P2	Junctions & footways added	15/09/15	DT	DP
P1	First Issue	03:11:14	DP	AB
Rev	Description	Date	By	App

P - Preliminary
C - For Construction

Bingham : Hall Associates
Oakleigh Connaught Rd
Attleborough
Norfolk NR17 2BW
Tel 01953 456806
email: office@binghamhall.com
website: www.binghamhall.com



Project Title
**Land at Lakenheath North
Station Road Lakenheath**

Drawing Title
Highway Layout

Drawn by DP	Checked by AW	Approved By AB
Size A3	Scale As shown	Date Nov 2014

Drawing No. 2806.SK13	Rev P2
--------------------------	-----------